

Lancashire
County Council

Public Rights of Way
PROW@lancashire.gov.uk
01772 530317

PUBLIC PATH DIVERSION ORDER
TOWN AND COUNTRY PLANNING ACT 1990, SECTION 257
LANCASHIRE COUNTY COUNCIL
DIVERSION OF 9-12-FP2 AND PARTS OF 9-12-FP1, 7-4-FP5
AT FARINGTON SMALL HOLDINGS ESTATE, STANIFIELD LANE, LOSTOCK HALL
PUBLIC FOOTPATH DIVERSION ORDER 2022



Plan Ref: 211-740v1(2of2)

This Map is reproduced from the 1:2000 Ordnance Survey material with the permission of Ordnance Survey on behalf of the controller of Her Majesty's Stationery Office (C) Crown Copyright.
Unauthorised reproduction infringes Crown Copyright and may lead to Prosecution or civil proceedings. Lancashire County Council Licence No. 100023320
The digitised Rights of Way information should be used for guidance only as its accuracy cannot be guaranteed. Rights of Way information must be verified on the current Definitive Map before being supplied or used for any purpose.

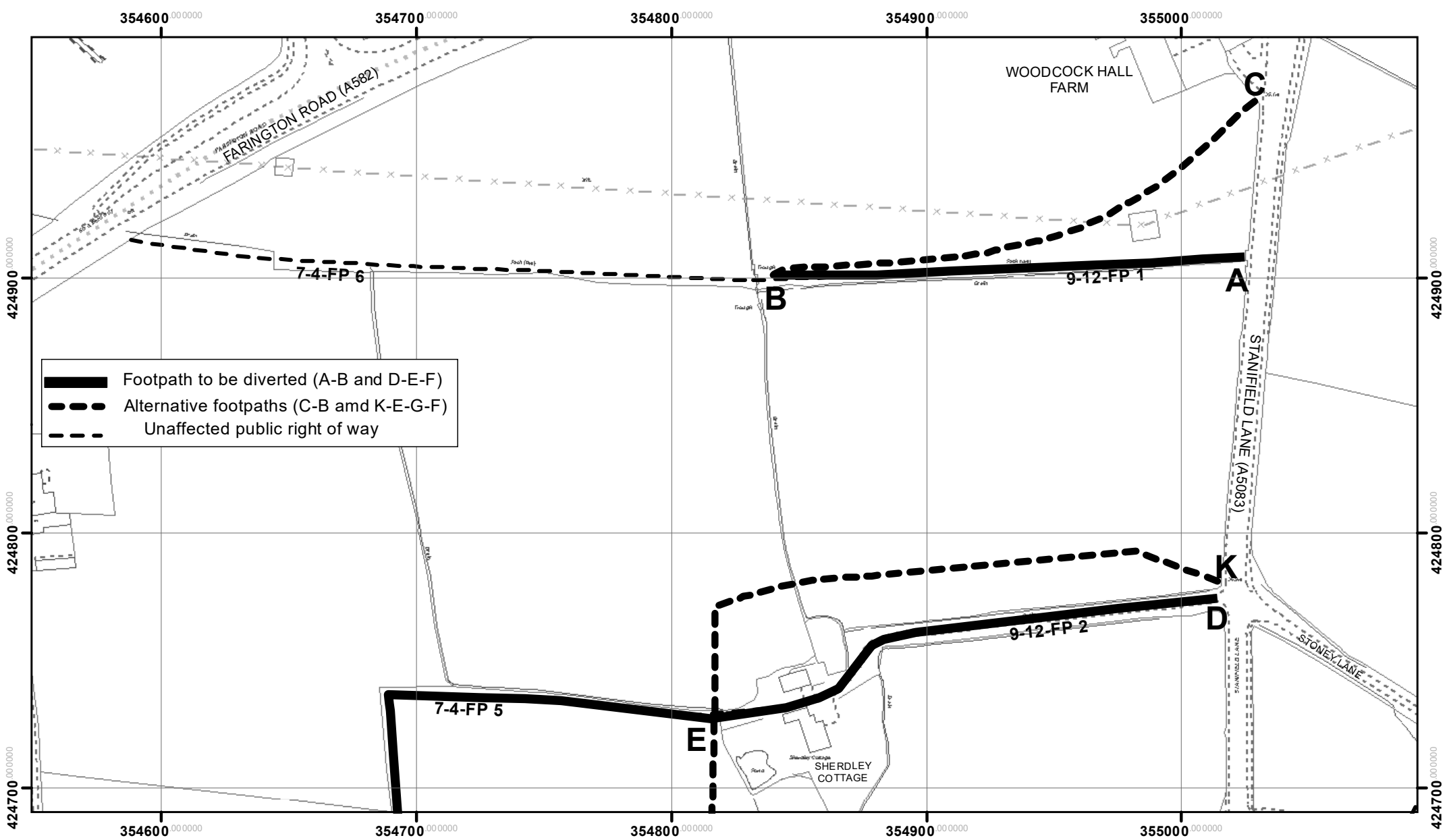

Lancashire
County Council
Public Rights of Way
PROW@lancashire.gov.uk
01772 530317

PUBLIC PATH DIVERSION ORDER
TOWN AND COUNTRY PLANNING ACT 1990, SECTION 257
LANCASHIRE COUNTY COUNCIL
DIVERSION OF 9-12-FP2 AND PARTS OF 9-12-FP1, 7-4-FP5
AT FARINGTON SMALL HOLDINGS ESTATE, STANIFIELD LANE, LOSTOCK HALL
PUBLIC FOOTPATH DIVERSION ORDER 2022



Plan Ref: 211-740v1(1of2)

This Map is reproduced from the 1:2000 Ordnance Survey material with the permission of Ordnance Survey on behalf of the controller of Her Majesty's Stationery Office (C) Crown Copyright.
Unauthorised reproduction infringes Crown Copyright and may lead to Prosecution or civil proceedings. Lancashire County Council Licence No. 100023320
The digitised Rights of Way information should be used for guidance only as its accuracy cannot be guaranteed. Rights of Way information must be verified on the current Definitive Map before being supplied or used for any purpose.